

EVERGREEN CEMETERY  
(1001 Hancock Ave.)

LEON YOUNG  
SERVICE CENTER  
(1521 - 1561 Hancock Expy.)

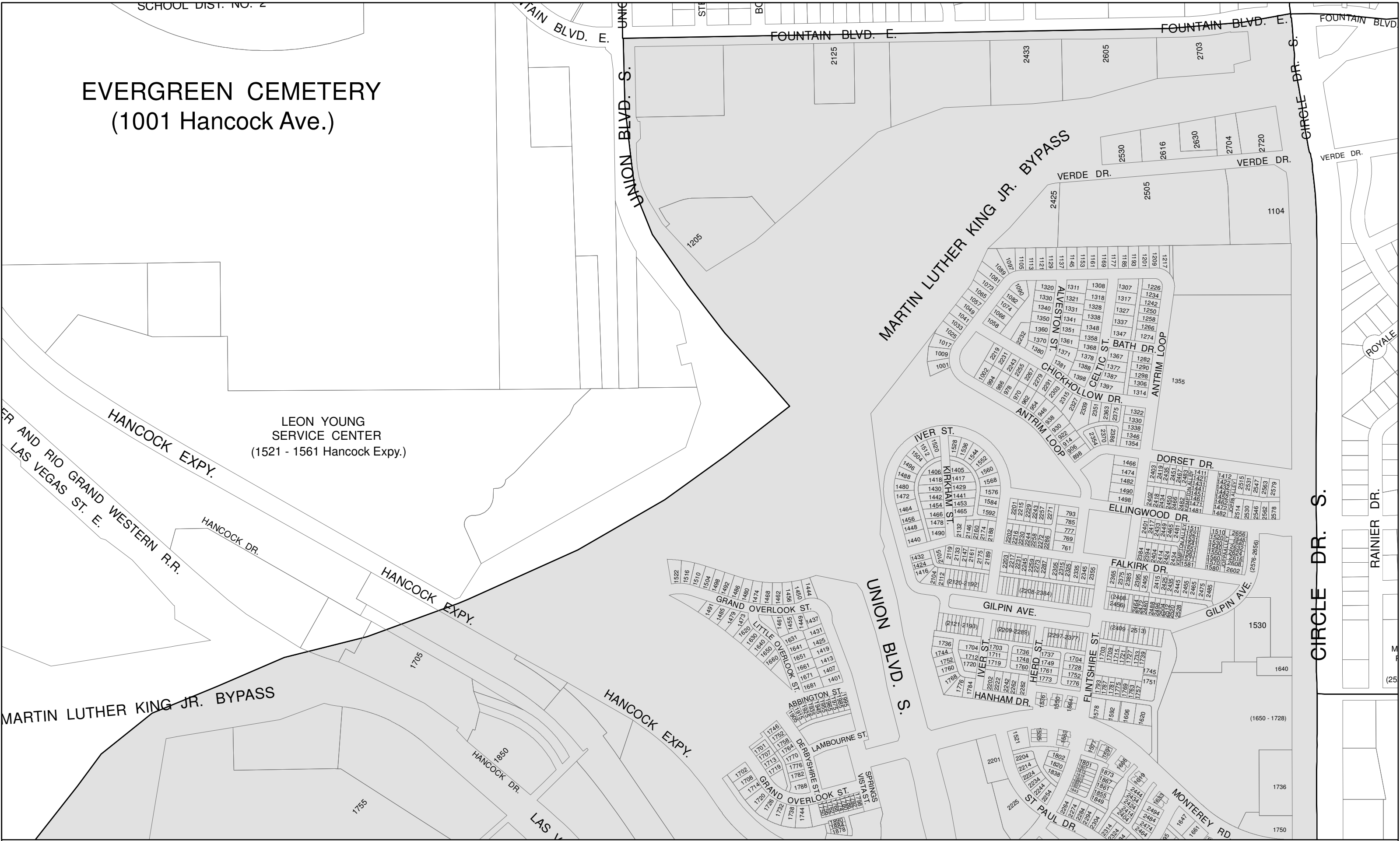

COPYRIGHT 2017 by the Board of County Commissioners, El Paso County, Colorado.  
All rights reserved. No part of this document or data contained herein may be  
reproduced; used to prepare derivative products; or distributed without the  
specific written approval of the Board of County Commissioners, El Paso County,  
Colorado. This document was prepared from the best data available at the time  
of plotting and is for internal use only. El Paso County, Colorado, makes no  
claim as to the completeness or accuracy of the data contained herein.

Scale: 1 inch = 417 feet  
Date: June 22, 2017

Precinct 610  
El Paso County, Colorado

This precinct is in the following districts:  
County Commissioner District 5  
State Representative District 17  
State Senate District 11

Map 1 of 2

